

Modern and Futuristic

# Trail Blazer- BlackMOA™ Portable Cassette Stove

User manual





# User Manual for BlackMOA™ Portable Cassette Stove

Ensure you have gone through this user manual before proceeding to use this stove. Understand each item as it's important for a better camping experience. In case of an emergency contact 111.

---

## Important Safety Information

1. **Read these instructions carefully** before using the appliance.
  2. **Use outdoors only** or in well-ventilated areas to avoid the build-up of dangerous gases.
  3. **CAUTION\***: Accessible parts may be very hot during and after use. Keep **young children** away from the appliance.
  4. Always ensure the appliance is placed **on a stable, flat surface** before use.
  5. **Check seals and connections** before use to ensure there are no leaks.
  6. If you **smell gas**:
    - **Do not ignite the appliance.**
    - Move the appliance to a **well-ventilated area** away from any sources of flame.
    - **Check for leaks** using soapy water (never use a flame to check for leaks).
  7. Do not use the appliance if it has **damaged seals** or if it is leaking.
- 

## Product Specifications

- **Model:** Trail Blazer (BM-1001)
  - **Gas Type:** Butane
  - **Nominal Heat Input:** 2600W
  - **Ignition:** Electric
  - **Pressure Range:** 0.5 - 2 bar
  - **Consumption:** 190g/h
  - **Category:** Outdoor Gas Burning Appliances
  - **Cylinder Spec:** 250g Butane Gas Cartridges
  - **Size:**
    - **Extended:** 275 x 80 x 105 mm +  $\varnothing$  260 x 100 mm
    - **Folded:** 250 x 90 x 105 mm
  - **Weight:** 1.4 kg
-

## Before First Use

### 1. Assembly:

- The appliance is **pre-assembled**. No further assembly is required.
- **Gas cylinder** should be **properly installed** by aligning it with the compartment (as shown in the product design) and ensuring it's securely connected.
- **Check the seals** for any damage before connecting the gas cartridge.

### 2. Installation & Usage:

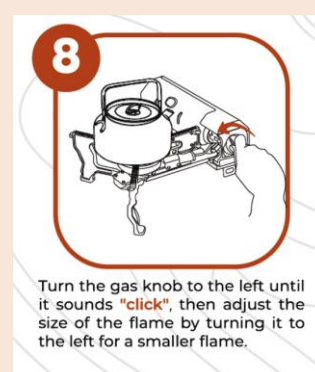
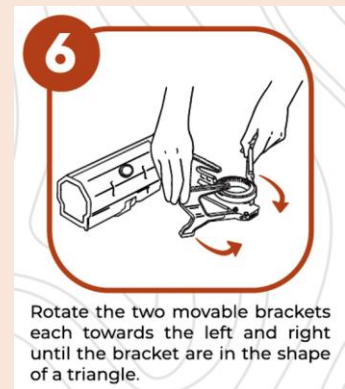
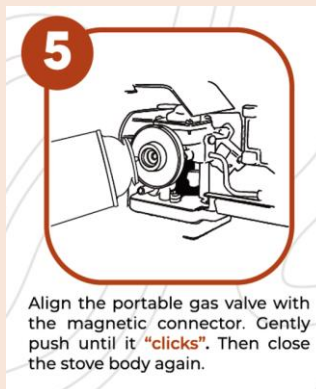
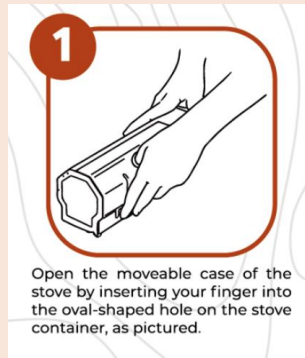

- 
- Place the appliance **outdoors** or in a **well-ventilated** space away from any flammable materials.
  - The stove should be placed on a **flat, stable surface** to avoid tipping over, especially when extending the burner arms (as seen in the product design).
  - **Do not leave the appliance unattended** while in use.
  - **Avoid moving** the appliance while it is in operation to prevent tipping or spills.

## Maintenance and Care

### 1. Cleaning:

- **Turn off the appliance** and allow it to cool before cleaning.
- Clean the stove surface with a **damp cloth**. Do not use **abrasive** materials that may damage the surface.
- The burner and gas inlet must remain free from dirt or grease to ensure proper operation.

### 2. Storage:

- Store the appliance in a **dry, cool place**, away from direct sunlight and **heat sources**.
- Disconnect the gas cylinder when not in use.
- Ensure the appliance is **disconnected** and **gas is turned off** before storing.

### 3. Replacement of Parts:

- **Replace seals** or other parts only with **approved parts** from the manufacturer.
- **Do not modify** the appliance in any way as this may pose a safety risk.

---

## Troubleshooting

Problem	Solution
<b>No flame</b>	- Ensure gas cylinder is securely connected.
	- Check that the ignition button is working.
<b>Gas leak</b>	- Turn off the appliance immediately. Check for leaks using soapy water.
	- If the leak persists, replace the seals and reconnect.
<b>Low flame or no flame</b>	- Check the gas pressure; ensure it is within the required range (0.5 - 2 bar).
	- Clean any dirt or blockages from the burner.

## Disposal

- Dispose of the appliance in accordance with **New Zealand regulations**
- Do not dispose of the appliance or any parts in **fire** as it could explode.

---

## Contact Information

For support, parts, or other inquiries, please contact:

**Myst Enterprise Ltd.**

Website: [www.mystenterprise.com](http://www.mystenterprise.com)

Email: [info@mystenterprise.com](mailto:info@mystenterprise.com)

